



**BUILT TO ORDER.
BUILT TO LAST.**

Arva Industries specializes in building high quality, heavy equipment that improves job site safety and productivity.



MC SERIES: MINING SCALERS

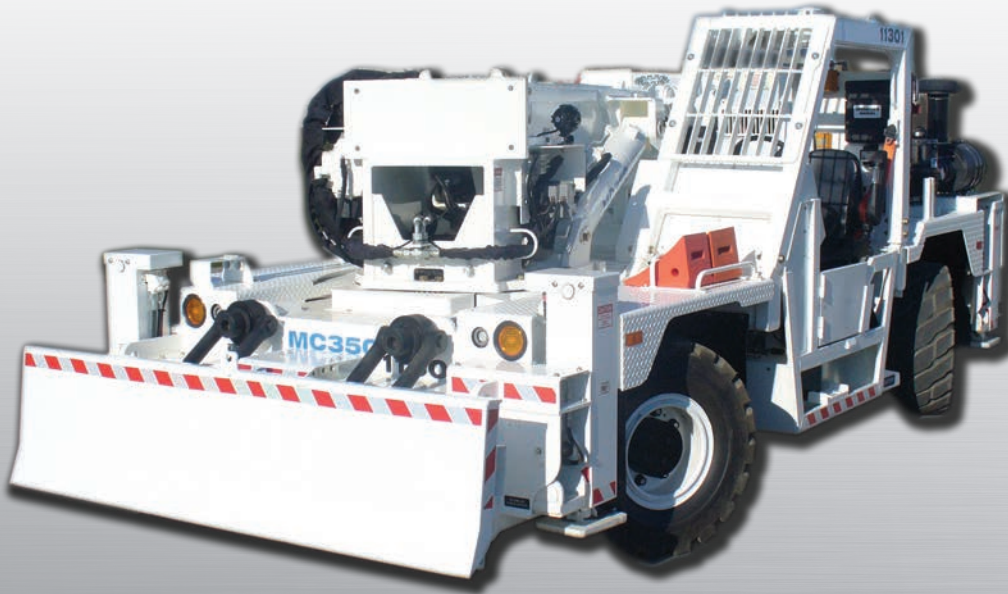

Optional Cutting
Head Attachment



MC350

The MC350 is a compact, robust and versatile scaling machine. Quick attach option allows for multiple attachments, including a manual pick, vibratory pick and rock cutting head scalers. The front-mounted plow complements the scaling capabilities with 0°-5° rotation left to right. Controls include LED lighting, CANbus rocker switches and multifunctional joysticks in cab with an optional radio remote for maximum safety, visibility and productivity.



Optional Manual Pick
Attachment

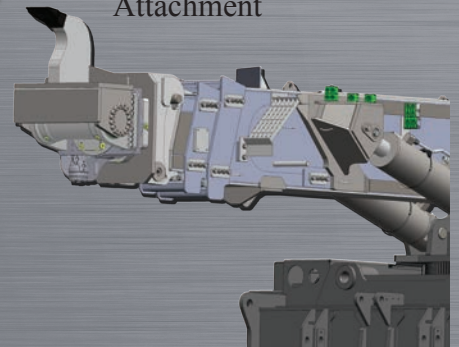

Optional Vibratory Pick
Attachment (not shown)



ARVA engineers robust, mine-ready platforms, like the MP430-60. This diesel-powered mobile carrier has a ROPS/FOPS certified Operator's canopy, out-and-down outriggers, a 360° continuous rotation telescoping 4-section boom (extended length 61.5 ft.) and a self-leveling 100° rotating boom tip mounted 2,000 lb. capacity work platform (with a range of +/-65° over front, sides and rear).



MC SERIES: LOW PROFILE CRANES

MC400 / MC500 SERIES

Deutsch waterproof electrical connectors, marine grade corrosion resistant tinned wire, and optional stainless steel hydraulic fittings make ARVA machines ready for the long haul.

Expertly welded for ultimate chassis strength with low centre of gravity, while integrated out-and-down outriggers provide solid stability and compact machine width.

High capacity winch for maximum single line pick capability, especially required in low height conditions.

Spacious Operator compartment has ergonomically positioned controls for maximum comfort.

Full-time four-wheel drive and optional four-wheel steering allow for maximum driving capabilities.



MC500

Cabs are ROPS / FOPS certified.

4" air ride seat with vibration dampening shock absorption provides a safe and comfortable ride.

ARVA heavy lift cranes are unmatched in the industry for their exceptional low profile pick & carry capabilities. The ARVA MC Series allows Maintenance Technicians to install, repair and get large equipment up and running faster than ever before. Produced, tested and certified by one manufacturer, an ARVA crane will make your operation more productive, efficient and safe, right from the start.



MC430

SPECIFICATIONS:

Model	Capacity tons @ 10 ft./ tonnes @ 3 m	Pick & Carry tons @ 10 ft. (horiz.)/ tonnes @ 3 m	HEIGHT ft./m	WIDTH ft./m	LENGTH ft./m	BOOM LENGTH Extended (ft./m)	Minimum Outside Turning Radius (four- wheel steer) (ft./m)
MC200	10 / 9.1	3.4 / 3.1	6.5 / 2	6 / 1.8	16 / 4.9	23 / 7	11.5 / 3.5
MC230	10 / 9.1	3.4 / 3.1	6 / 1.8	6 / 1.8	16 / 4.9	23 / 7	11.5 / 3.5
MC300	15 / 13.6	5.2 / 4.7	6 / 1.8	7 / 2.1	18.4 / 7.25	24 / 7.3	17.3 / 5.3
MC430	20 / 18.1	8.2 / 7.4	7 / 2.1	8.3 / 2.5	20.1 / 6.1	26 / 7.9	19.5 / 5.9
MC500	25 / 22.7	5 / 4.5	7.25 / 2.2	8 / 2.4	21.3 / 6.5	26 / 7.9	22 / 6.7

*** Quick attach boom tip attachment hydraulics available on MC210, MC240, MC310, MC410, MC430, MC510

MC200 / MC300 SERIES



MC200

ARVA cranes have more than twice the boom side loading capability than the competition to assist with swinging heavy loads in rough terrain.

Unique forward boom placement permits negative boom angles for ultimate access and, when swung to the rear, it provides a compact footprint for easy tramping.

Full-time four-wheel drive and selectable steering modes get you where you need to go.

Cabs are ROPS / FOPS certified.

Designed for mining conditions and regulations, including ROPS/FOPS, dual braking and approved fire suppression system.

Boom tip hydraulics available for ultimate lifting versatility.

Radio remote control option for maximum safety and productivity.

High capacity winch for 24,500 single line pull, especially required in low height conditions.



MC310

ARVA low profile cranes offer industry leading lifting capacities at the lowest operating heights available. These rugged designs have been engineered to withstand the harsh environments of underground mining, but every ARVA crane can be tailored to meet your specific job site needs. Infinitely variable, advanced hydraulic controls allow for smooth operation and precise load placement.

Quick-Connect Power: Boom tip attachments and hydraulics transform your crane into an everyday use tool. Pick from a variety of options, including a cable sheave, luffing jib, work platforms and custom attachments, as required.



ROCK CUTTER



SELF-LEVELLING 2 PERSON WORK PLATFORM



RADIO REMOTE CONTROL



LUFFING JIB



SHEAVE END ATTACHMENT

SV SERIES: SERVICE VEHICLES

The ARVA SV Series is a specifically designed air suspended vehicle for underground mining operations, including maintenance and emergency operations. The Series is based on a versatile chassis, which offers a wide variety of application specific configurations to meet your toughest requirements. These purpose built vehicles are built from the ground up for maximum durability and productivity. The high capacity payload, smooth riding air suspension, industrial grade components and full customization flexibility make ARVA the first choice in long life utility vehicles.

- Four-wheel drive
- Four-wheel steer
- Low profile 72"
- Cab forward designed with ride damping air suspension allows for Operator visibility and comfort
- 12,000 lb. payload capacity



The SV12140 Belt Service Vehicle is equipped with a conveyor belt locking mast lift kit, optional crane, storage rack, toolbox and power inverter.



SV12140 BELT SERVICE VEHICLE

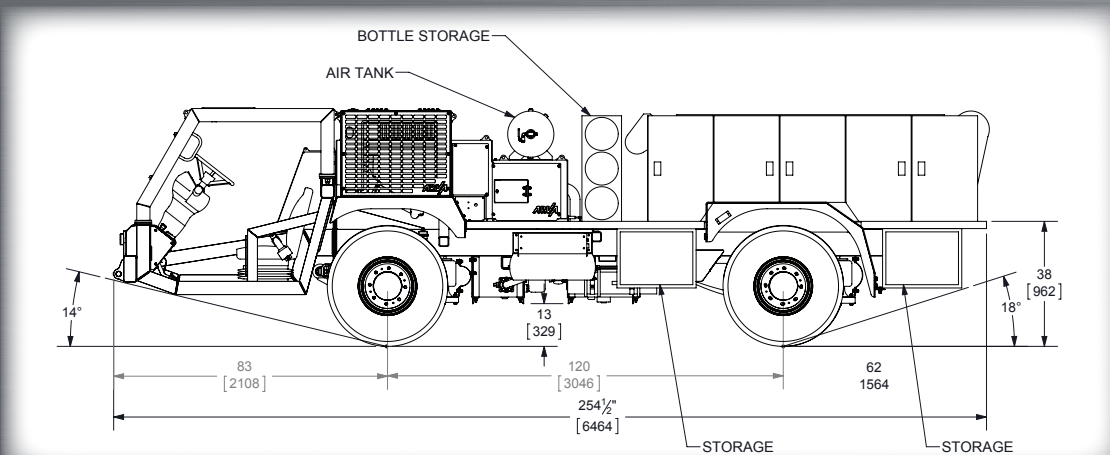

SV12160 MECHANIC'S SERVICE VEHICLE



Both the SV12120 and SV12125 Water Service Vehicles are equipped with water kits, including a plastic water tank and stainless steel spray system with 4 nozzles. Variable controls and matched speed allow for ultimate dust control. A versatile design allows for different water capacities and flow rates.

SV12125 1,000 US GALLON WATER SERVICE VEHICLE

The SV12130 Mine Rescue Vehicle features 6 person seating, centre stretcher area, tool cabinets and an optional power inverter.



SV12130 MINE RESCUE VEHICLE

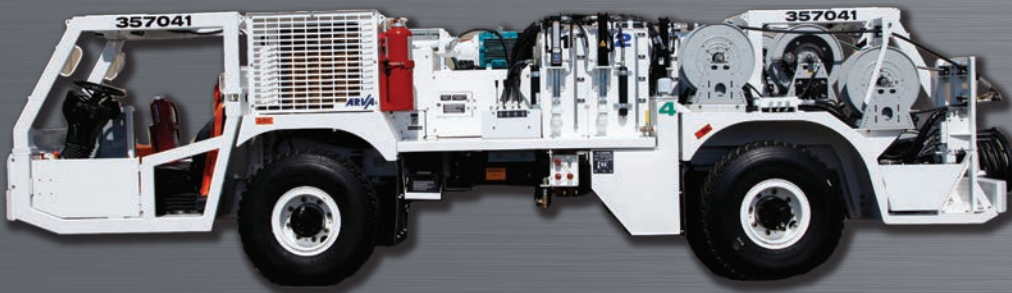

Both the SV12100 and SV12105 Lube Service Vehicles offer a hydraulically-driven lube kit with separate tanks for various lubricants. In addition, the SV12100 with optional front and rear Operator cabs for limited operating spaces is built with forward and rear driveable positions.

SV12100 FRONT AND REAR CAB LUBE SERVICE VEHICLE

ALL TERRAIN CRANES: MODEL AT3035

ARVA designs and produces the highest quality, longest lasting, most innovative specialty cranes available. The ARVA AT3035 Crane is no exception. The AT models are designed specifically for customers who demand a high capacity, compact crane able to handle the demands of rough terrain work sites. The proven 130 hp. Cummins® diesel engine, hydraulic disc brakes, rugged four-wheel drive and Dana powershift transmission allow the AT3035 crane to travel safely at speeds of 22 mph. The cab forward design permits excellent visibility and the lowest overall crane heights available on the market. Cab comfort features allow Operators to work effectively for longer periods with less fatigue, and an integrated load-moment system allows them to lift confidently and safely.

Designed with specialty, high strength T1 steel, this machine can easily lift 7.5 tons, but the vehicle weight is a remarkably light 25,470 pounds. With each axle weight under 13,000 pounds, 96 inches in total height and 96 inches in width, this air transportable unit provides military and emergency response support across the globe.

AT Cranes are built entirely at the ARVA production facility with every component inspected and tested by our Quality Department. Quick and reliable spare parts delivery provides you flexible global support when and where you need it. With proven reliability, easy maintenance and quality features, AT Cranes are designed to enhance your crew's productivity and help you achieve a safer work environment.

From compact three-section booms to lightweight extended reach models, ARVA Engineers can customize your machine to meet your lifting and transportation needs.

High capacity lifting in an ultra-compact frame, featuring full 360° rotation, make an ARVA AT3035 Crane a flexible choice for contractors needing a hybrid design.



The cab forward design features large windows providing Operators with a clear view of the load and fewer blind spots.

Single or dual person cabs maximize the interior space, featuring deluxe seats, ergonomic controls and climate control for year round comfort.

Four-wheel drive and 3 modes of steering allow Operators to maneuver closer to the lift in tight work areas, even when faced with adverse ground conditions.

SPECIFICATIONS:

Model	Capacity max (tons/ tonnes)	Pick & Carry max (lb. / kg)	Boom Sections	Height, Width, Length (ft./m)	Boom Length Ext. (ft./m)	GVW (lb. / kg)	Seating
AT3035M	7.5 / 6.8	8,150 / 3,696.8	2	8.1, 8, 26.2 / 2.5, 2.4, 8	40 / 12.2	25,000 / 11,339.8	Single
AT3035D	7.5 / 6.8	8,000 / 3,628.7	2	8.1, 8, 26.2 / 2.5, 2.4, 8	40 / 12.2	25,500 / 11,566.6	Dual

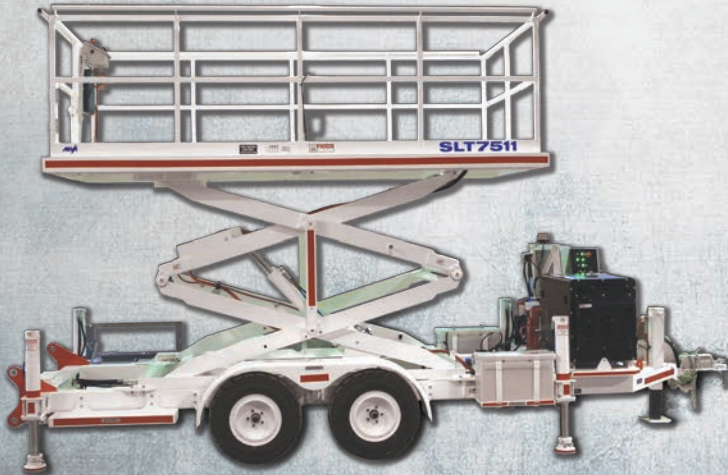

SCISSOR LIFT WORK PLATFORM TRAILER

The ARVA SLT7511 lift trailer is ready for work in remote locations. This self-contained work lift features an onboard 6500 watt diesel generator for tool, air and hydraulic system power. The large elevated platform is supported by a structural frame with four hydraulic outriggers. Easily towed, this twin axle trailer smoothly handles rough terrain with torsion suspension and 10" of ground clearance.



GIRAFFE WORK PLATFORM

When large overhead projects require a boost in productivity, the ARVA Giraffe Work Platform is the answer. This amazing 17' X 40' aerial platform brings the ceiling down to ground level. The 20,000 lb. capacity makes fewer reloading trips required, keeping the focus on the work at hand. A hydraulically operated telescopic staircase allows workers to access the deck even at the 23' maximum working height. The platform rotates 360° continuously for ultimate reach and flexibility. Multiple electric and air platform circuits are everything workers need to get the job done.



CEILING PANEL LIFTER

This unique solution has saved millions of dollars in tunnel construction while providing a safe, efficient way to raise and install ceiling panels, and is capable of lifting 30 tons to 23'. The ARVA Ceiling Panel Lifter makes short work of a once difficult job. The 28° of front to back deck adjustment allows the integrated 15,000 lb. winch to slide panels up and onto the unit. Panels are then raised, rotated, tilted and shifted for perfect placement every time. This work platform is job site tested and ready to provide years of dependable service.

SPECIFICATIONS:

Model	Description	Capacity Max. (lb/kg)	Platform size Width, Length (ft. / m)	Height (lowered / raised) (ft. / m)	Platform Rotation from Centre (Degrees)
SLT7511	Scissor Lift Work Platform Trailer	2,000 / 907.2	6, 12 / 1.8, 3.7	6.5, 14.5 / 2, 4.4	0
SLAR1740	Giraffe Work Platform	20,000 / 9,071.8	17, 40 / 5.2, 12.2	10, 23 / 3, 7	360
SLAR60PH	Ceiling Panel Lifter	60,000 / 27,215.5	12, 40 / 3.7, 12.2	10, 23 / 3, 7	90

CONVERSIONS TO CRANES

Arva Industries helps breathe new life into older machines by repurposing existing excavators, reconfiguring them into specially designed cranes.

Save the cost of buying new and let Arva Industries convert an already tough and reliable machine into something new and productive.



**CRANE FOR CAT 245
- CAPACITY OF 5
TONS @ 60' BOOM**



**ML120 CRANE FOR CAT 345D
- CAPACITY OF 83 TONS @ 7' BOOM**

ARVA Marine Cranes and Davits are tailored to meet exact customer requirements with certification for safe and long life operation. Engineers constantly improve upon proven designs for increased performance, reliability and efficiency in extreme conditions. Advanced in-house surface treatment of metal structures is suitable for marine environments and guarantees long-term corrosion resistance.

DESIGNS INCLUDE:

- Electro/hydraulic telescoping multi-section booms
- Fixed length cranes with rigid booms
- Luffing davits for launching and recovery of boats

- Certified designs
- Reliable performance
- Precision controls
- Radio remote control
- Constant tension winch



SPECIFICATIONS:

Model	Example	Capacity (tons / tonnes)	Boom Length Extended (ft./m)	Boom Sections	Boom Elevation (Degrees)
AR1652	CCGS Griffin	15 / 13.6	60 / 18.3	1	0 / 80
AR4800	CCGS Limnos	15 / 13.6	8.5 / 2.6	3	0 / 60
AR5500	Canadian Navy	2.75 / 2.5	21 / 6.4	1	0 / 90

RAIL MAINTENANCE

ARVA rail equipment is built for safety, productivity and durability. Since 1995, Arva Industries has provided innovative rail maintenance solutions to North American transit systems. ARVA specializes in producing both powered and non-powered cars for a wide variety of maintenance needs, including track vacuuming, snow clearing, emergency car recovery, ballast handling, catenary inspection, tunnel washing, asbestos removal, material handling and mobile scaffolding.

Arva Industries offers complete design flexibility to meet your exact project requirements. That is the ARVA difference.

TRACK UTILITY VEHICLE

The ARVA Track Utility Vehicle (TUV) is a versatile machine that can be outfitted with a variety of options, including Snow Removal Plows, Blowers, Third Rail De-icing, High Pressure Leaf Removal Spray, Utility Crane for track maintenance support.

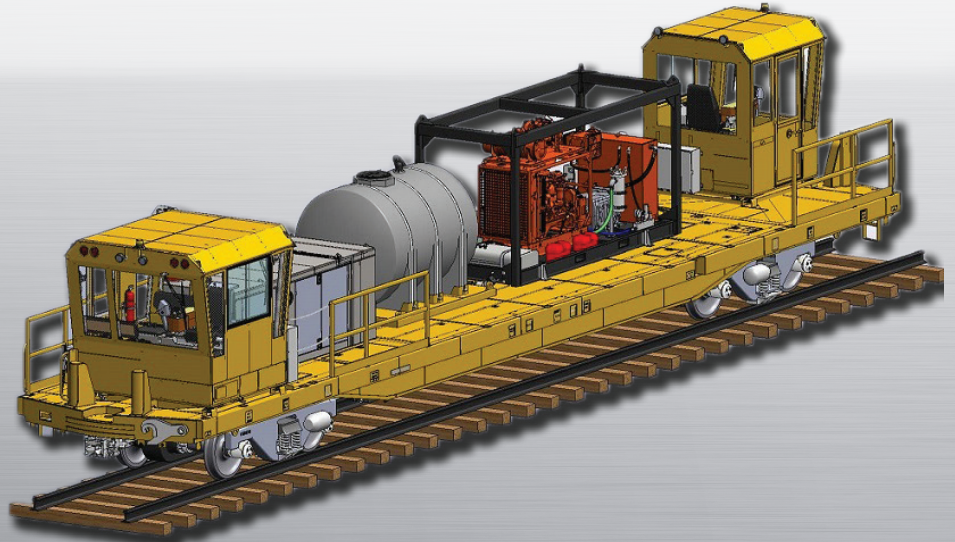

35 TON RAIL BOUND CRANE

- Maximum Lift - 35 Ton
- 3 Section Telescopic Boom - equal reach over both ends
- Maximum Pick & Carry of 15,000 lbs. over each end @ zero degree in tunnels
- 360 degree turning with Outriggers
- Maximum axle load in travel mode will not exceed 30,000 lbs
- Cummins QSL9 - 380 hp Tier IV Engine
- 4 axle Hydrostatic Drive - Maximum Speed 40 mph

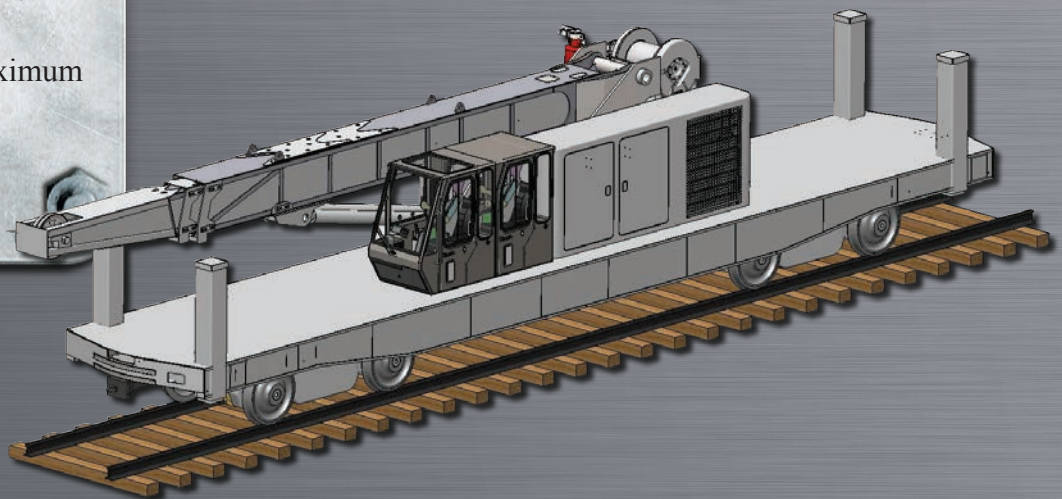
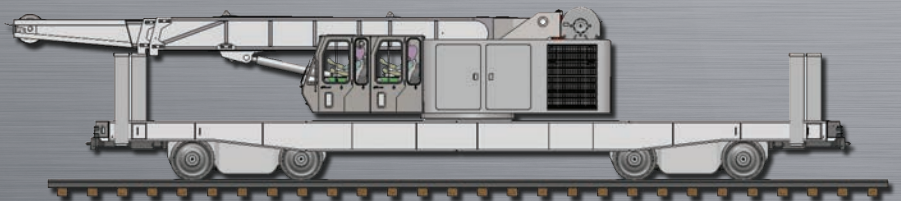

OVERHEAD CATENARY INSPECTION MULTI-PURPOSE MAINTENANCE VEHICLE

The ARVA Overhead Catenary Inspection Vehicle will allow your technicians to be more efficient, effective and thorough. Your inspectors will use both a telescoping work platform for overhead work and a knuckle-boom with personnel basket for hard to reach areas. The climate-controlled Operator's cab will provide maximum comfort while providing optimal forward visibility. With seating for up to ten, an optional washroom and kitchenette, this multifunctional car will increase team efficiency and improve on-track safety.



DUAL CAB SUPER PRIME MOVER

ARVA's Dual Cab Super Prime Mover is a safe, sturdy and dependable work car for coupling auxiliary cars, as well as transporting personnel, supplies and equipment to the job site. Large ARVA Operator cabs provide exceptional comfort and optimal forward visibility for better range of view and operation.



HYDROSTATIC WORK CAR

These powerful units are designed to safely transport a variety of equipment and supplies to the job site. Even more functionality is gained when equipped with an optional ARVA crane package, including remote control, telescopic boom and outriggers. The standard climate-controlled Operator's cab provides optimum forward visibility for both Operator and passenger.



VACUUM CARS

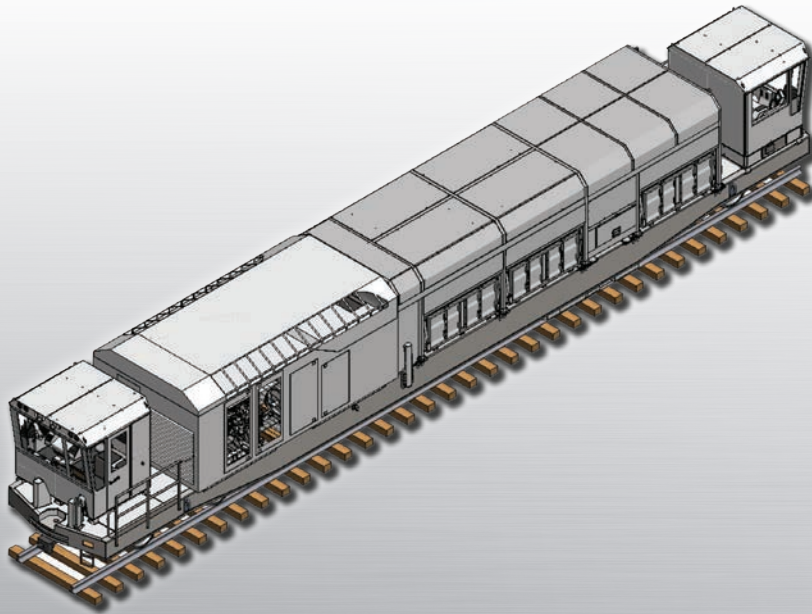

TRACK VACUUM VEHICLE

The ARVA Tunnel Vacuum Car is designed to remove debris, such as discarded newspapers, cans, bottles, leaves, steel dust, etc. from the track bed in subway systems.



BALLAST EXCAVATOR WORK CARS

A clean rail system is a safe rail system. Let us customize a vacuum work car to your specifications. We have designed systems to clean sewer drains, collect steel dust, vacuum standing water, and for general debris clean up. A side-dumping, twenty yard bin allows for long in-service work times and the flexibility of multiple drop areas. A high pressure water system is available for blasting and jetting areas, when required.



BALLAST DELIVERY HOPPER

The ARVA twenty yard delivery hopper is designed to haul ballast and distribute it evenly between the rails and/or outside the rail during maintenance work programs. Couplers on each end allow for multiple cars to be pulled for greater capacity. Manual and remote control functions are available for independent or combined chute control.

NON-POWERED FLATCAR

The ARVA non-powered flatcar is designed to safely handle and transport a variety of rail maintenance tools, equipment and supplies to the job site. The rugged frame can be easily equipped with an ARVA crane package, including remote control, telescopic boom, outriggers and safety load monitoring system. Let ARVA customize, design and manufacture your next flat car.

ARVA specializes in engineering rail frames built for a lifetime of dependable service.

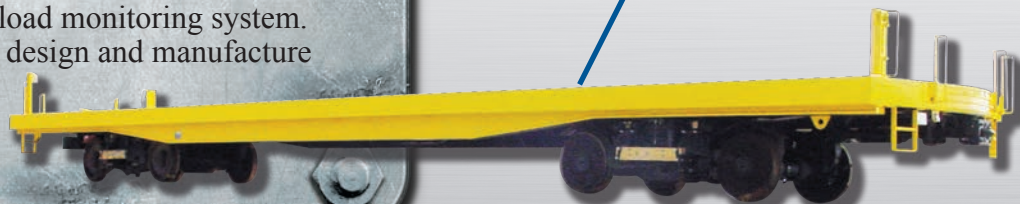

HIGH PRESSURE TUNNEL WASHER

The ARVA High Pressure Tunnel Wash car is a trusted solution for cleaning subway tunnels and 3rd rail insulators. The 6,000 gallon, large capacity water tank allows for extended work blocks, while the 3,000 psi full coverage wall wash pressure provides maximum cleaning power. When needed, draw upon a full 8,000 psi of water pressure for washing individual insulators.



CUSTOM RAIL CRANES

ARVA Industries has a crane solution for all your lifting and material handling needs. In-house Engineers can customize a capable deck-mounted crane or retrofit and certify an existing work car that will meet your ever-evolving needs.



IN-HOUSE ENGINEERING

ARVA Industries designs and manufactures specialized rail maintenance cars for repair and service operations. Our in-house Engineering Department integrates with your team to ensure complete satisfaction from concept to commissioning. From custom solutions to money saving refurbishments, ARVA is your partner in maintaining a safe and efficient rail system.



For over 35 years, Arva Industries has been providing innovative solutions, technical support and personalized customer service. Organizations like yours consistently seek out our expertise for solutions to unique challenges. Our Engineering Department uses the latest technology to design, develop and certify industry leading machinery. Every unit is backed by long-term spare parts availability, Field Service Technicians, training and certification. Today, ARVA equipment is at work across the globe. We deliver the performance and reliability that you require to get the job done - on time and on budget.



Paul Smith, President
519-637-1855, ext. 211
psmith@arvaindustries.com



Shawn Smith, Vice President
519-637-1855, ext. 226
ssmith@arvaindustries.com



Kevin Spicer, Director of Engineering
519-637-1855, ext. 241
kspicer@arvaindustries.com



Wayne O'Shell, Sales Manager
519-637-1855, ext. 224
woshell@arvaindustries.com



Terry McQuillen, Senior Sales Consultant
519-637-1855, ext. 215
tmcquillen@arvaindustries.com



Sheri Fox, Sales & Service - Parts
519-637-1855, ext. 216
sfox@arvaindustries.com

ARVA Industries • 43 Gaylord Road • St. Thomas, Ontario • Canada, N5P 3R9
Phone: 519-637-1855 • Email: sales@arvaindustries.com • Web Site: arvaindustries.com